



TRAIL MAP

- A** Ski Shop
- B** Ticket Window, Rentals, Ski School
- C** Lockers
- D** Ski Patrol, Halfway Café, Candy Chute
- E** Chalets
- F** Legends, Sports Bar, Hunter's Grill
- G** Convention Center
- H** Treetops Lodge: Bar 81, Spa
- I** Jones Pro Shop
- J** Treetops Inn
- K** Extreme Tubing Park

- Restrooms
- Dining
- Spa
- Candy Chute
- Ticket Window
- Terrain Based Learning (TBL)

TRAIL DIFFICULTY

- EASIEST
- INTERMEDIATE
- MOST DIFFICULT
- EXPERTS ONLY
- TERRAIN PARK

TREETOPS.COM/ACTIVITIES
989-732-6711

SKI PATROL: 989-731-8433
SKIER SERVICES: 989-731-8430

Stay in control. People ahead of you have the right of way. Stop in a safe place for you and others. When starting downhill or merging, look uphill and yield. Use devices to prevent runaway equipment. Observe signs and warnings. Keep off closed trails. Know how to use the lifts safely.





TRAIL MAP

CROSS COUNTRY SKIING, FAT TIRE BIKING, SNOW SHOEING

Need to schedule an activity?
TREETOPS.COM/ACTIVITIES
989-732-6711

WINTER PLAYGROUND ACTIVITY LEGEND

- | | | |
|---|---|---|
| A Ski Shop:
Sleigh Rides | G Treetops Inn:
Arcade Center,
Indoor/Outdoor Pool | L Ski Area:
Downhill Skiing, Snowboarding,
Extreme Tubing, Ski School,
Terrain Park |
| B Lockers, Rentals, Lift Tickets,
Ski School, Fat Tire Check In | H Convention Center | |
| C Ski Patrol, Halfway Café,
Candy Chute | I Treetops Lodge:
Ice Skating, Guided Snowshoe | |
| D Chalets | Hike, Scavenger Hunt, Spa,
Indoor/Outdoor Pool, Bar 81 | |
| E Legends, Sports Bar,
Hunter's Grill | J Treetops Jones Cottages | |
| F Tubing Check-in | K Jones Pro Shop:
Fat Tire Bike and Cross Country
Ski Trail Head | |

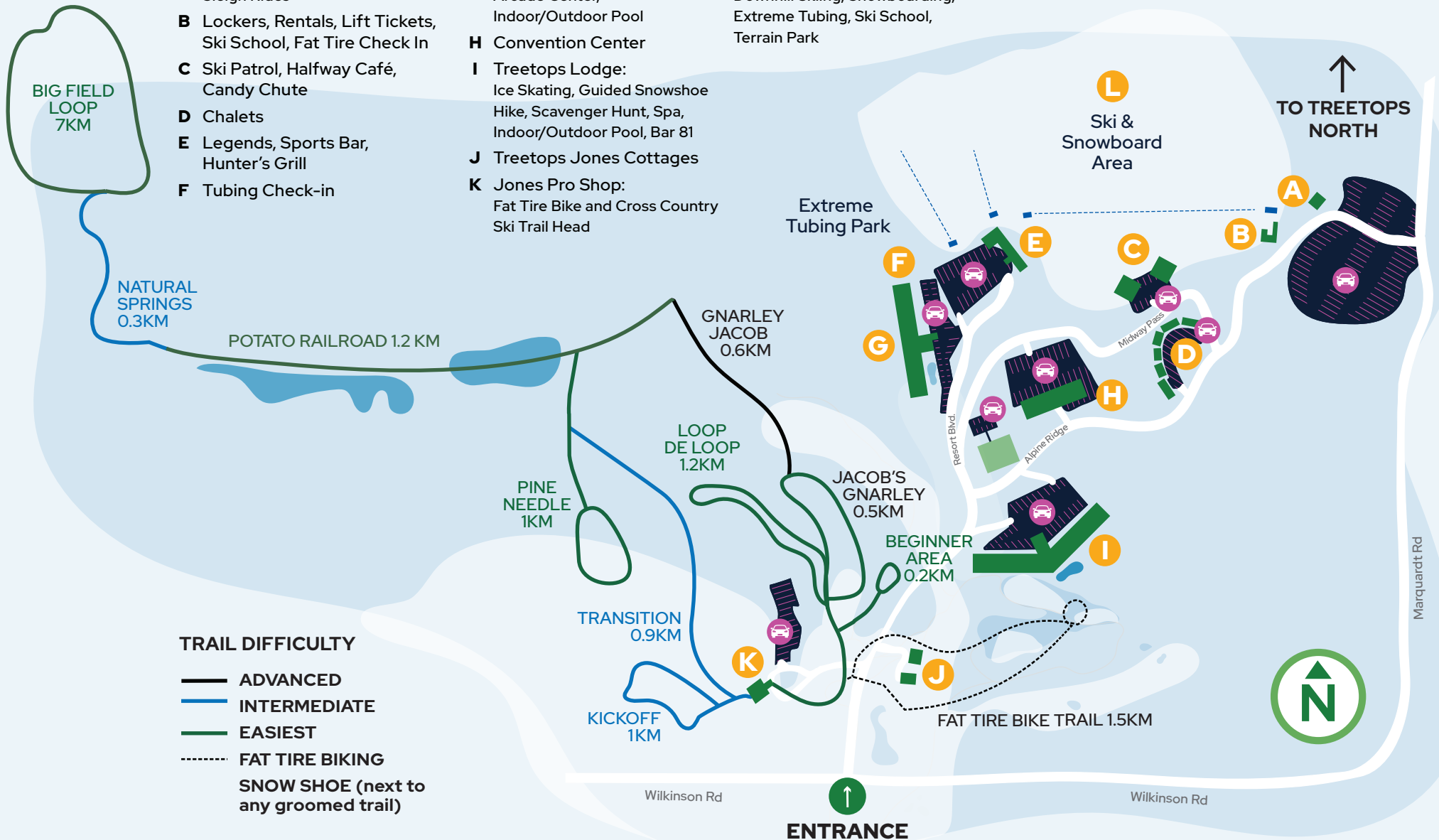

TRAIL DIFFICULTY

- ADVANCED
- INTERMEDIATE
- EASIEST
- - - - - FAT TIRE BIKING
- SNOW SHOE (next to any groomed trail)